

INDIVIDUAZIONE DEGLI AMBIENTI OGGETTO DEGLI INTERVENTI

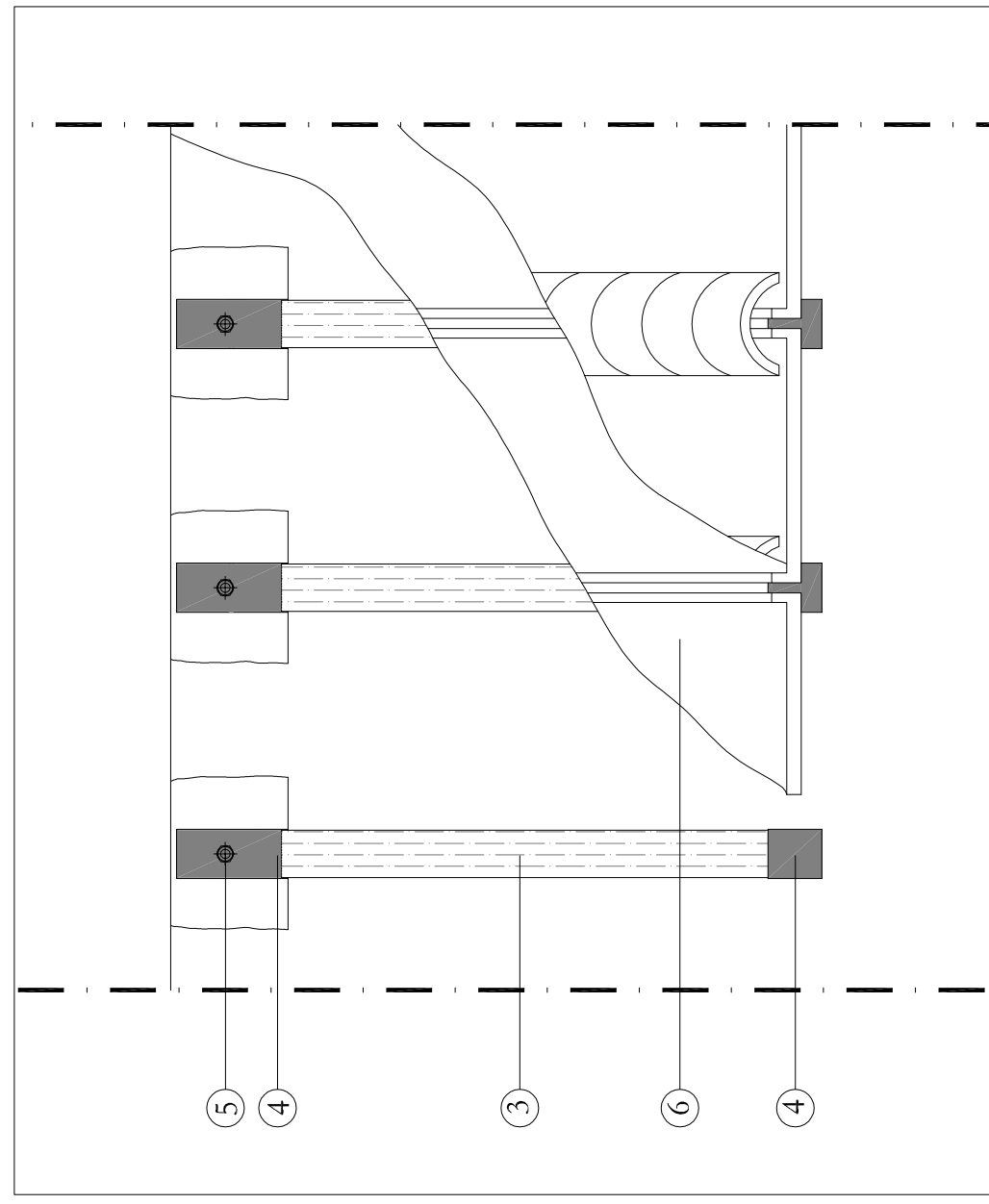

**Soprintendenza Speciale per i Beni Archeologici di
Pompei, Ercolano e Stabia**

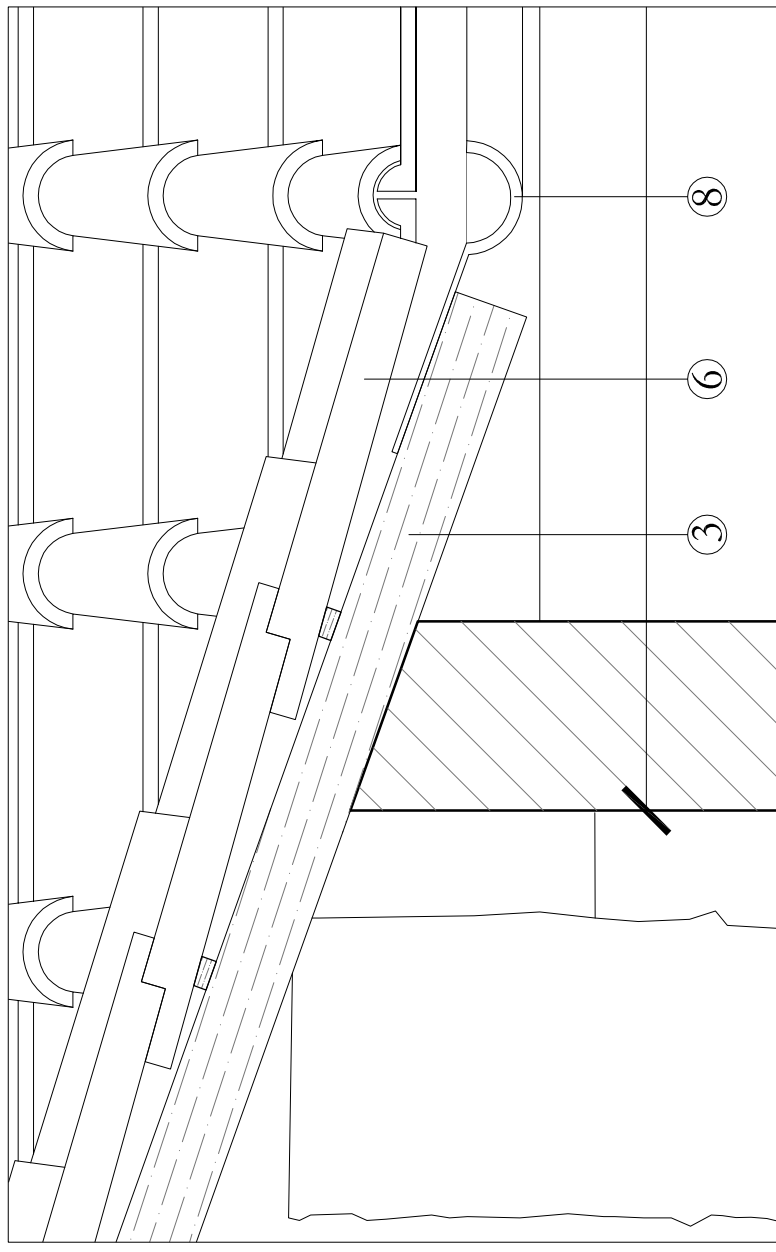
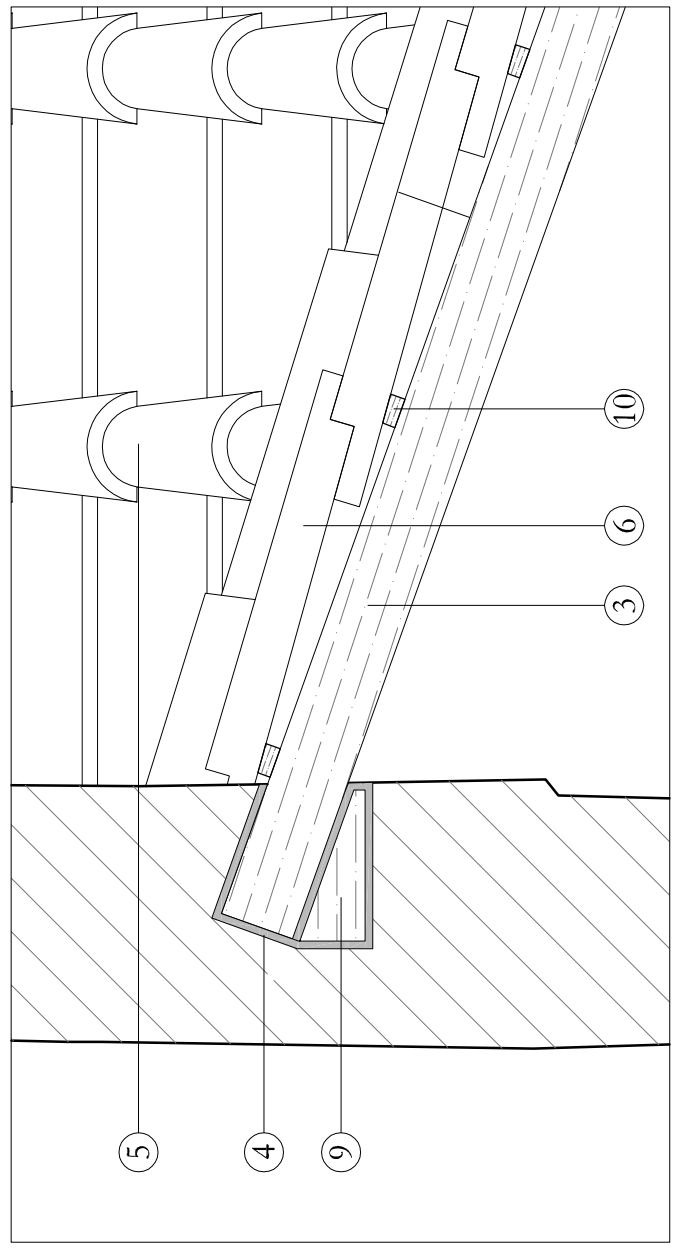
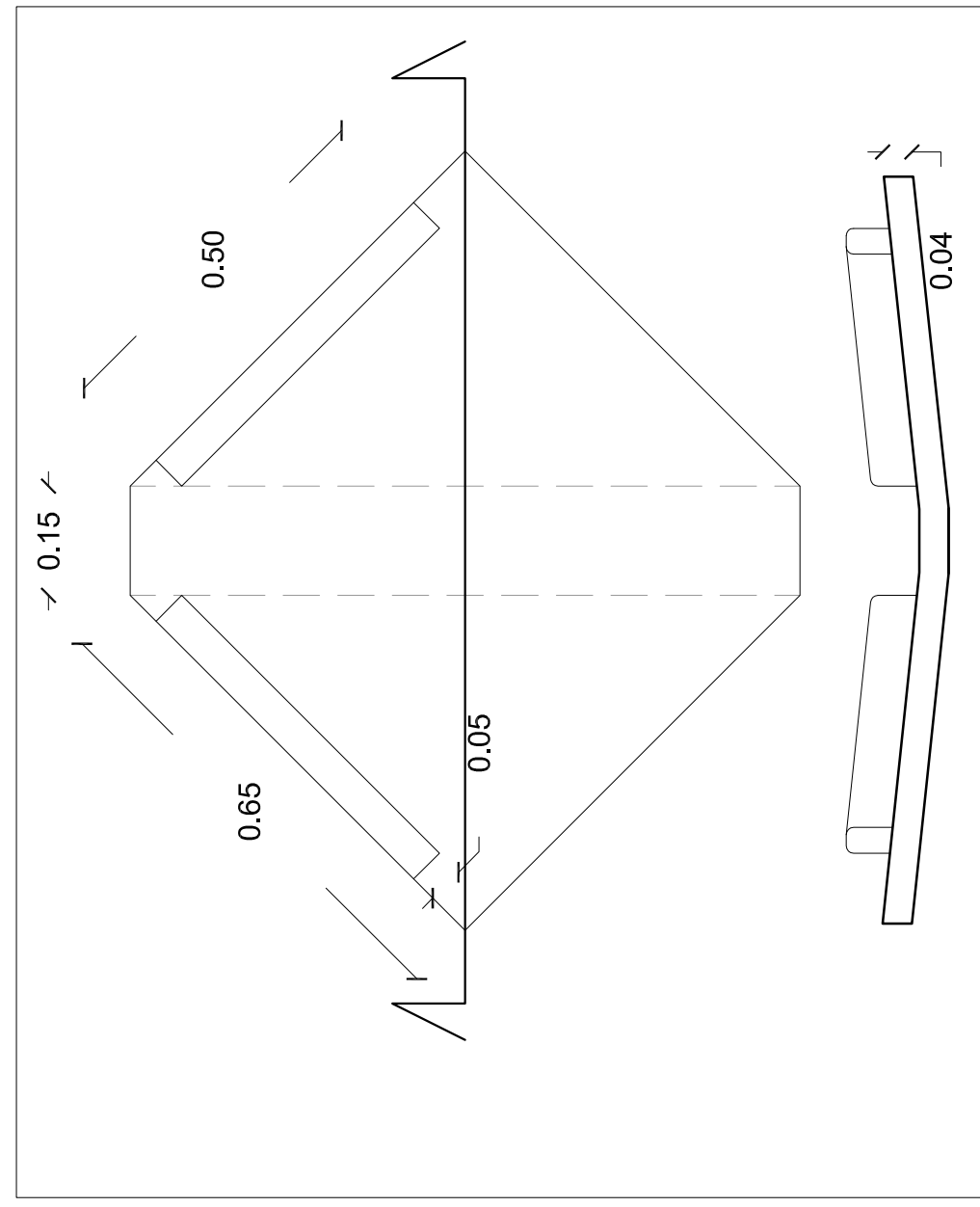
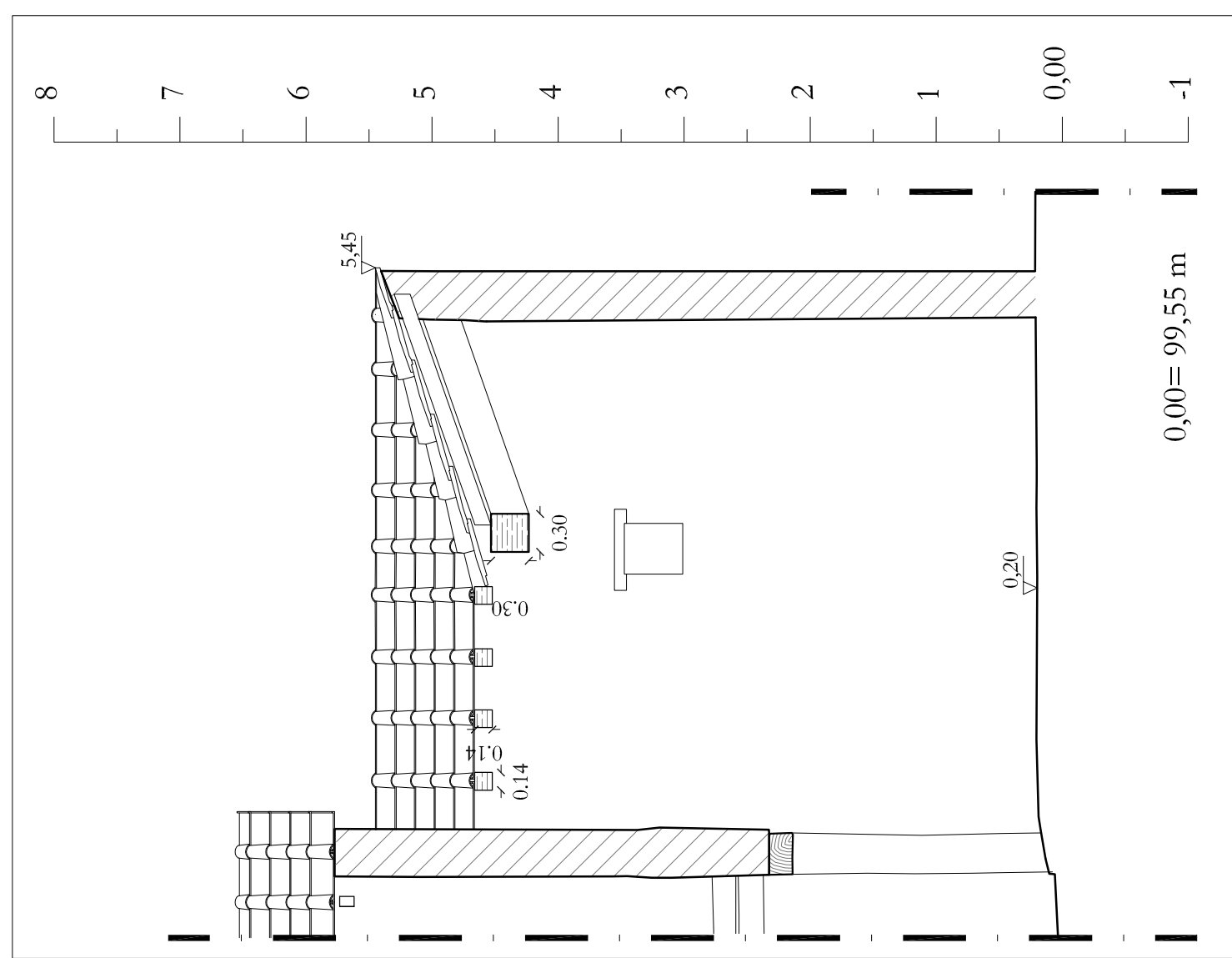
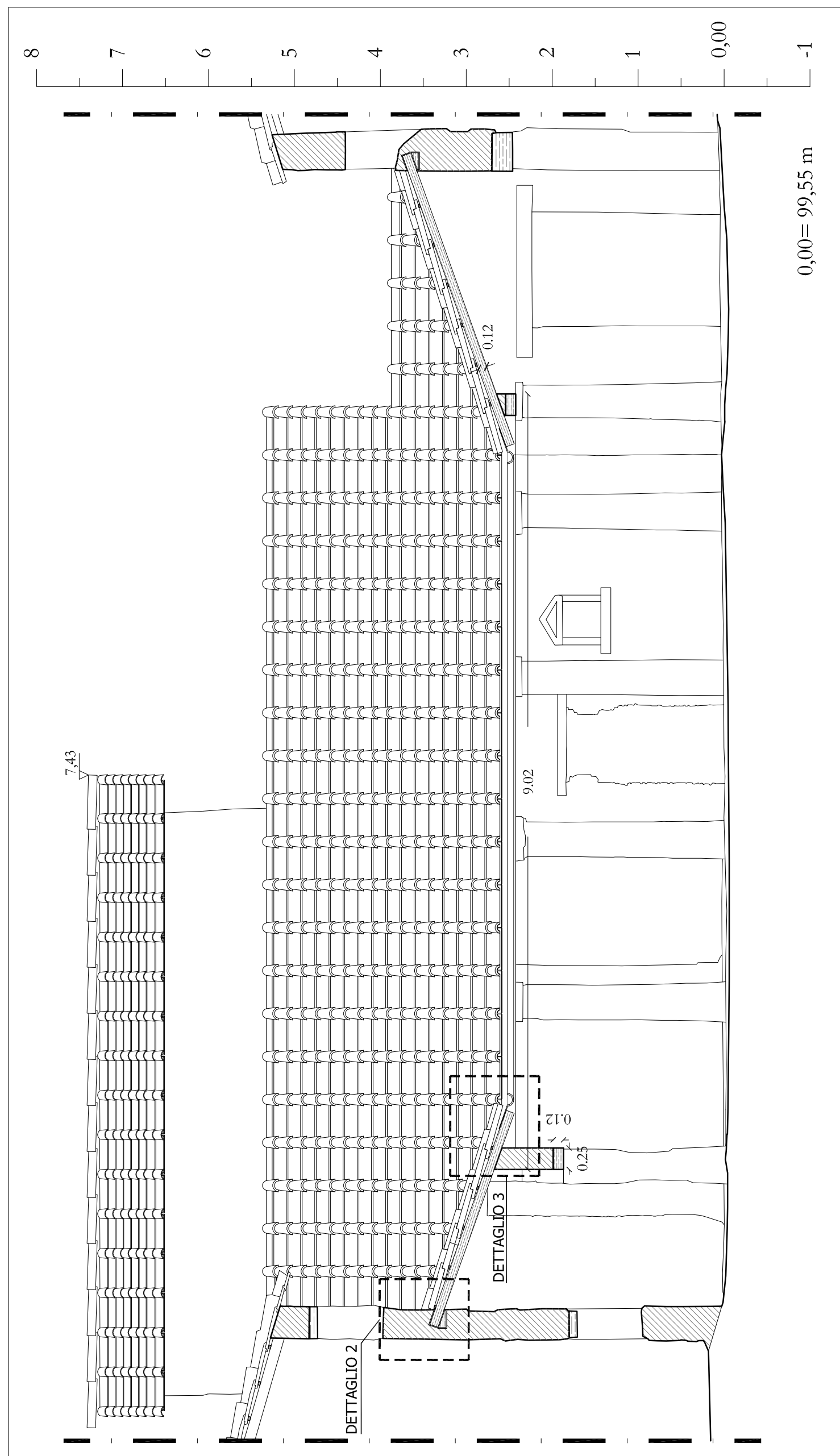
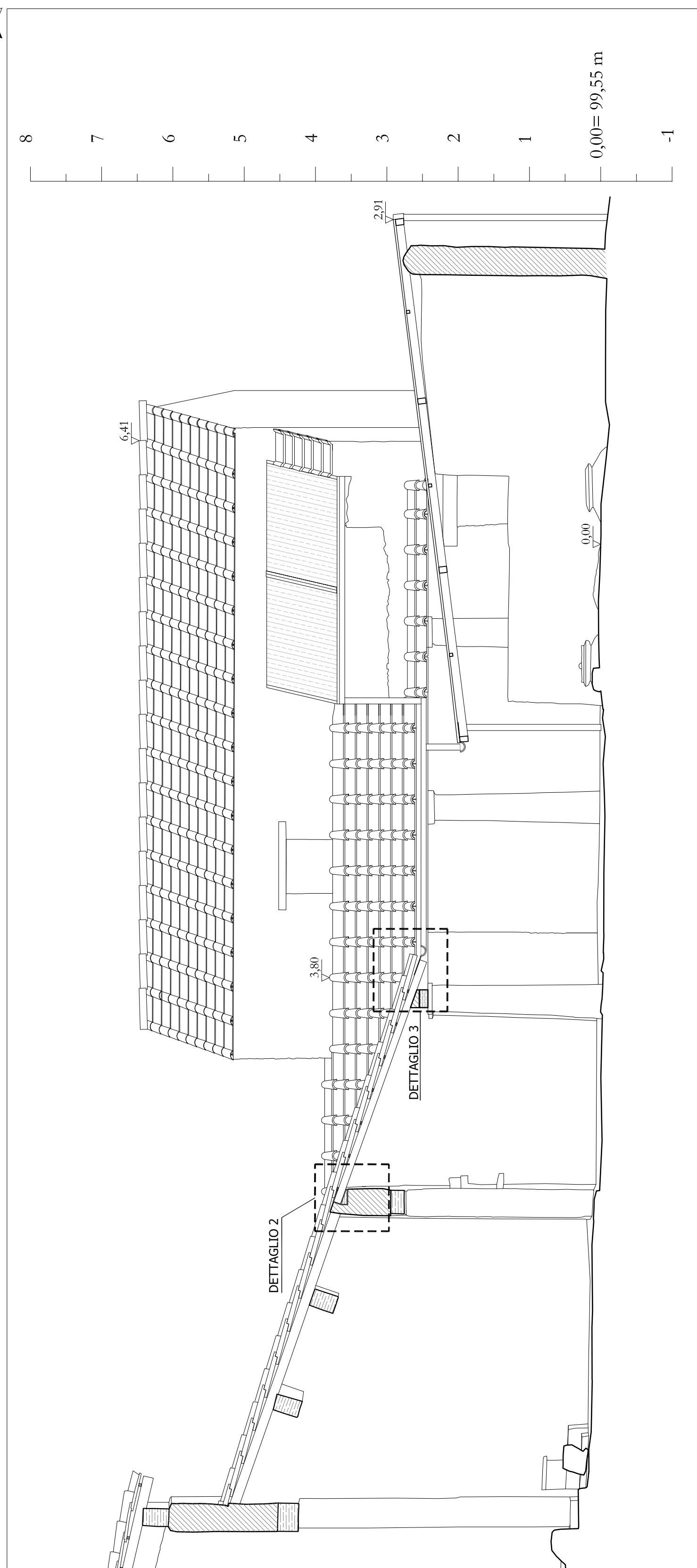
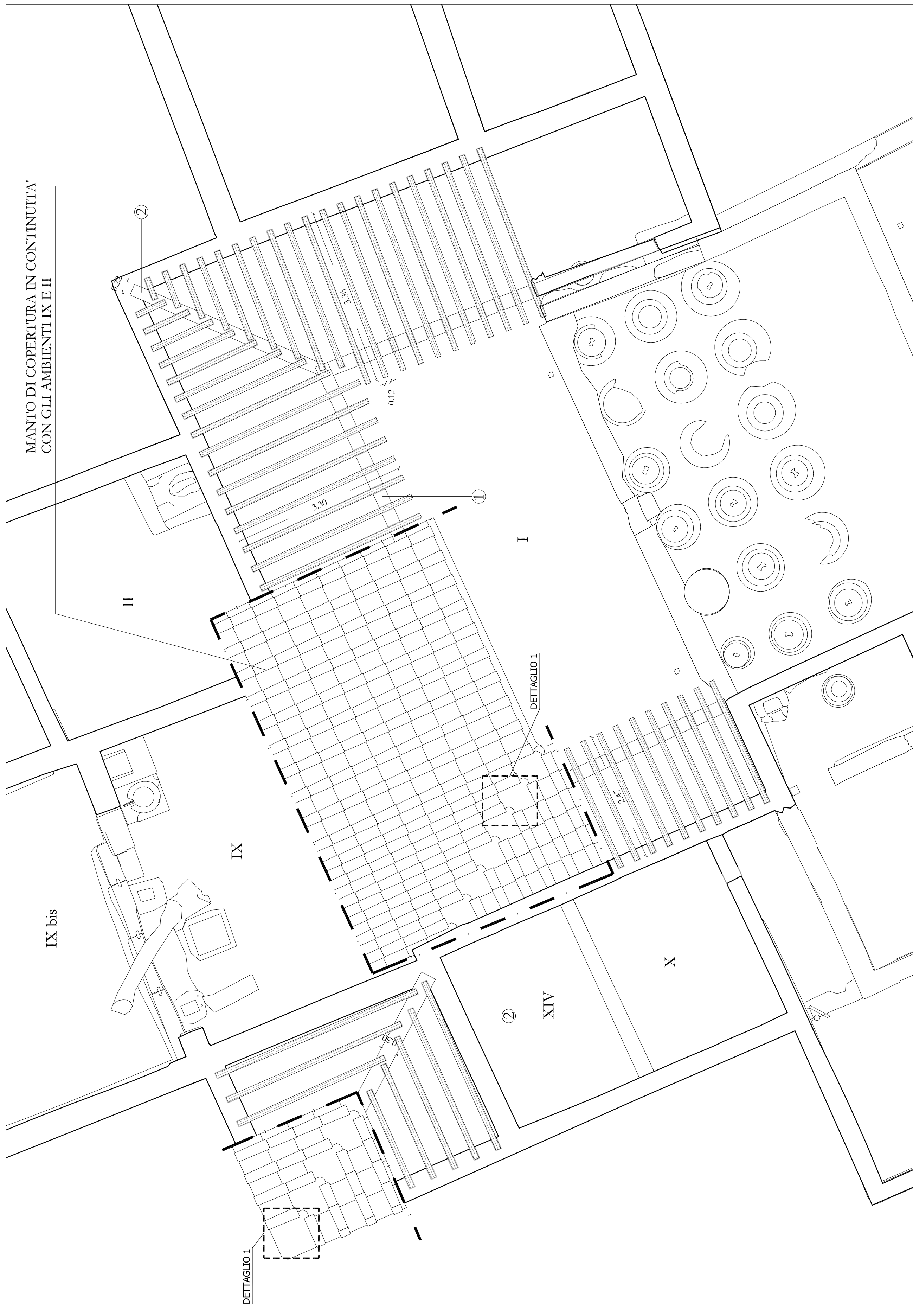
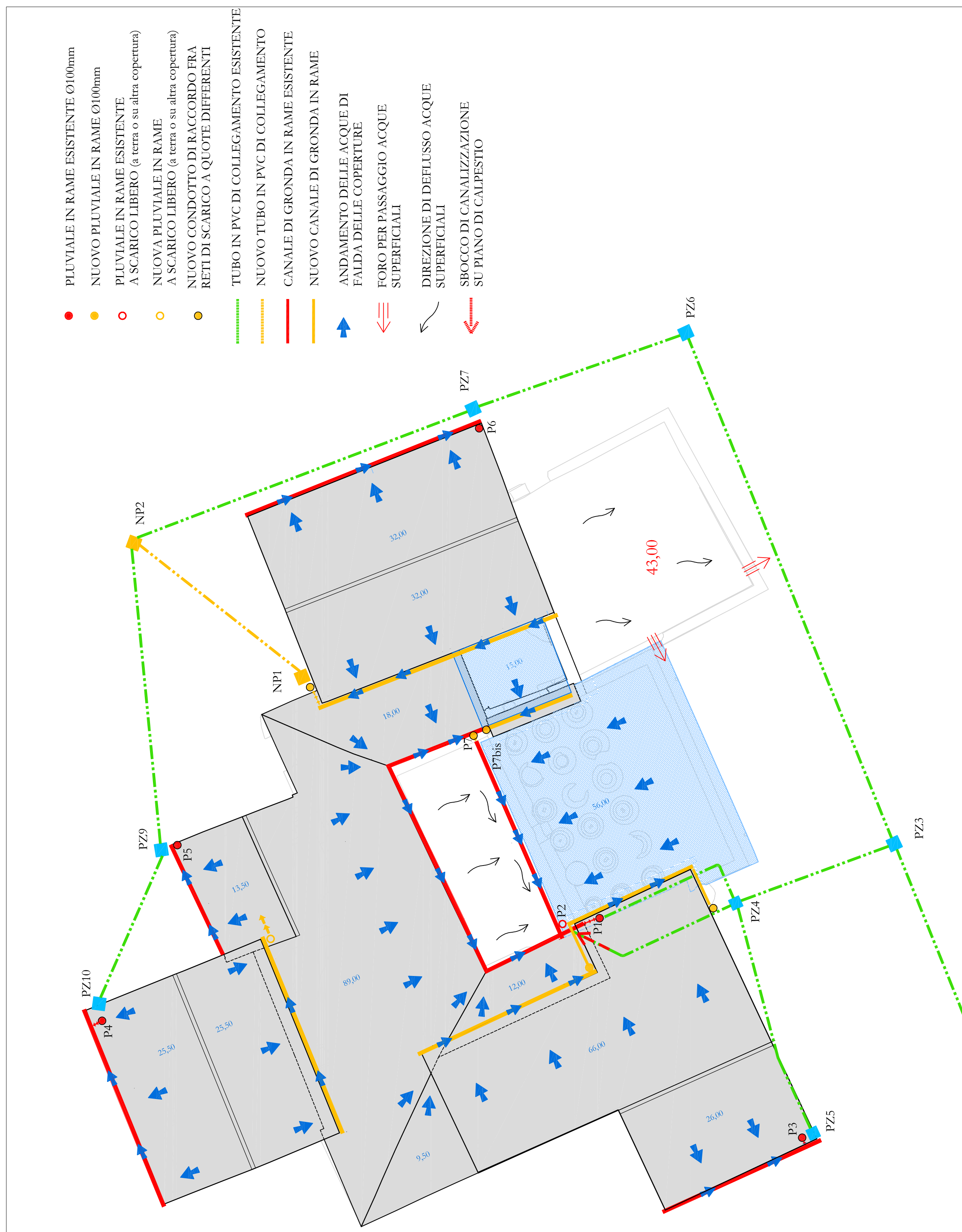
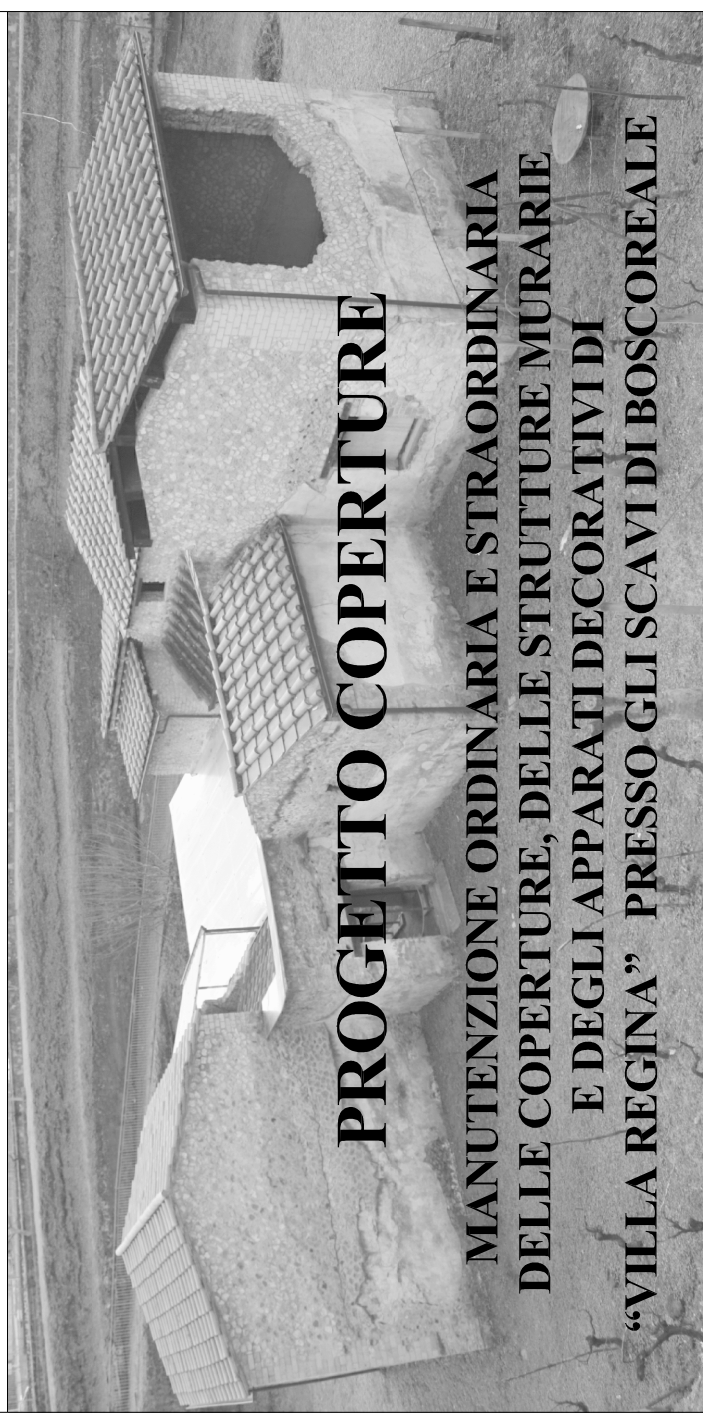

PROGETTO ESECUTIVO

<p>IL R.U.P.: Arch. Immacolata Begamasso</p>	<p>IL PROGETTISTA: Arch. Carlo Mondini</p>	<p>I CONSULENTI: <i>Per le opere architettoniche e le sup. decorative</i> Ing. Roberto Inghini <i>Per la struttura</i> Ing. Fabrizio Torretti <i>Per gli apparati decorativi</i> Ing. Roberto Inghini <i>Per le ricerche archeologiche</i> Dott. Domenico Camardo Dott. Mario Nicolazzi <i>Per la direzione dei lavori</i> Dott. Massimo Buzzi <i>Per l'impianto elettrico e la illuminazione</i> Ing. Franco Vizzarelli e Ing. Marco Di Manno</p>	<p>Firma:</p>
<p>IL SORINTENDENTE: Prof. Massimo Onana</p>	<p>IL DIRETTORE DEGLI SCANT DI BOSCOREALE: D.ssa Anna Maria Sola</p>	<p>Firma:</p>	<p>Firma:</p>

SEZIONE 4 scala 1:50

SEZIONE 3 scala 1:50

SEZIONE 5 scala 1:50